

To: Davis Joint Unified School District
 1919 - 5th Street
 Davis, CA 95616

Project: Davis Sr. HS, All Student Center-19-16-032

315 West 14th Street
 Davis, CA 95616
 Tel:
 Fax:

We submit for your approval the following cost estimate of changes in the work as follows:

DESCRIPTION OF CHANGE: CCD #005: Revised Electrical Site Plan

Added costs to revise the electrical underground to incorporate the additional power requirements at the robotics building per CCD #005.

REFERENCE DOCUMENT: As noted

Status: Quoted

Type	Reason	COR Number	
Change Order	Contract Scope Change		
Item	General Description		Applied
001	K&B Electric - Change Order #004	03 16-001 SC 000	\$84,171.00
002	CCD #005 - Concrete Demo (456 SF)	03 03-301 IC 000	\$1,368.00
003	CCD #005 - Concrete Patch (456 SF)	03 03-301 IC 000	\$3,126.00
004	Credit for Original Demolition	03 02-221 SC 000	\$-2,000.00
005	Credit for Original Concrete Patch	03 03-301 IC 000	\$-10,560.00
006	Credit for Original Asphalt Patch	03 02-311 IC 000	\$-8,000.00
007	RCON - OH&P @ 5.0%	03 70-001 IC 000	\$3,405.00
008	RCON - Bond @ 1.0%	02 01-090 IC 000	\$715.00
			\$72,225.00

Extension of time necessary for this change (calendar days) 0

We will not proceed with this change until receipt of a written directive or change order. This proposal must be accepted by: **12/16/2016**. If not accepted by the date, we reserve the right to re-evaluate the impact of the change

Please note this quotation includes direct cost of the work only. This quotation does not include any time or costs for delays or damages resulting from impacts as a result of this change order. Roebbelen reserves the right to seek these costs at a later date if necessary.

Roebbelen Contracting, Inc.

By _____
 Owner/Architect

By _____
 Signature

K & B Electric Inc

P.O. BOX 2233
Loomis, CA 95650
Lic. No. 937299
916 652 6524 Fax 916 404 4819
kandbelectric916@sbcglobal.net

PROPOSAL

DATE	PROPOSAL...
12/14/2016	1040

NAME / ADDRESS
Roebbelen Construction 1241 Hawks Flight Ct. El Dorado Hills, CA 95762

PROJECT
Change Order # 4

We take pleasure in submitting the following proposal in accordance with specifications included herein and subject to the conditions on reverse side hereof for acceptance within 30 days from the above date.
If this Proposal meets with your satisfaction, please sign and return the enclosed copy.

DESCRIPTION	COST	TOTAL
<p>Davis HS All Student Center Change Order # 4. REVISED PER ee COMMENTS ON 12-13-2016. This Change Order is based on CCD # 5 dated 12-1-2016. Complete electrical work on the above named project according to plans and specifications prepared by HMC dated 12-1-2016 and as follows:</p> <p>Inclusions: All electrical work as shown on CCD #5 and sheets E1.2 & E7.1. This estimate is based on Panel HD circuit 1, 3, 5 as a 90/3 instead of a 20/1 breaker as shown. And that an existing main breaker exists in Panel M. The price below reflects the delta difference between the original feeder route as shown on sheet E1.2 dated 9-19-2016 and CCD # 5. Cost breakdown sheets are attached. Time change to contract: 3 additioanl weeks.</p> <p>Addenda: None noted.</p> <p>Exclusions: Fees, permits. Trenching in solid rock. Concrete/Asphalt/Stucco/Drywall cut, core, bore, remove, replace. Spoils off site removal. MSB housekeeping concrete housekeeping pad. Hazardous material abatement. Roof penetrations. Roof patch. Attached terms.</p> <p>FOR THE SUM OF: \$84,171.00 K & B Electric Inc. DIR # 1000000210 The credit for the 800 amp Panel HM of \$2,044.00 had already been factored into our original proposal price.</p>	84,171.00	84,171.00
Accepted by: _____ Date: _____	TOTAL \$84,171.00	

Fax #
916-404-4819

SIGNATURE _____

- CONSTRUCTION NOTES:**
1. "LB" INTO (E) SWITCHBOARD SEAL PENETRATIONS WATER-TIGHT.
 2. SAW CUT CONCRETE AS REQUIRED. PATCH TO MATCH EXISTING.
 3. (E) 3-4" CONDUITS. PULL-IN WIRES. SEE ONE LINE DIAGRAM.
 4. EXTEND 1-4" CONDUITS TO PANEL-DPA. CAP 4-4" CONDUITS FOR SPARE.
 5. EXTEND CONDUIT FROM SIDE OF ENCLOSURE. RISE UP TO ROOF.
 6. ROUTE CONDUIT ON ROOF.
 7. DOWN TO MECHANICAL ROOF BELOW. SEAL ROOF PENETRATION WATER-TIGHT.
 8. VERIFY EXACT LOCATION ON JOB SITE PRIOR TO ROUGH-IN.
 9. DISCONNECT & ABANDON (E) FEEDER. RECONNECT AS REQUIRED.

Consultant
HARRY A. YEE & ASSOCIATES, INC.
ELECTRICAL ENGINEERS
4920 FREEMONT BLVD., SUITE D
SACRAMENTO, CALIFORNIA 95822
TEL: 916.454.5319
FAX: 916.454.4117
MYA Job #1568



Agency Approval
FILE NO. 57-H3
IDENTIFICATION STAMP
DIV. OF THE STATE ARCHITECT
APPL. 02-115086
ACS. _____ FLS. _____ SSS. _____
DATE _____

Project Title
ALL STUDENT CENTER
DJUSD Davis Sr. HS
215 West 14th Street,
Davis, CA 95616

No.	Description	Date
CCD-005	Electrical Service Revisions	12/01/16

Drawing Title:
ELECTRICAL SITE PLAN

Architect's Seal 	Designed: DY Drawn: HW-DB QA/QC: HY Date: 09/19/2016	Project No. 3447013.000 Scale: 1"=30'-0" Drawing No. E1.2
----------------------	---	--

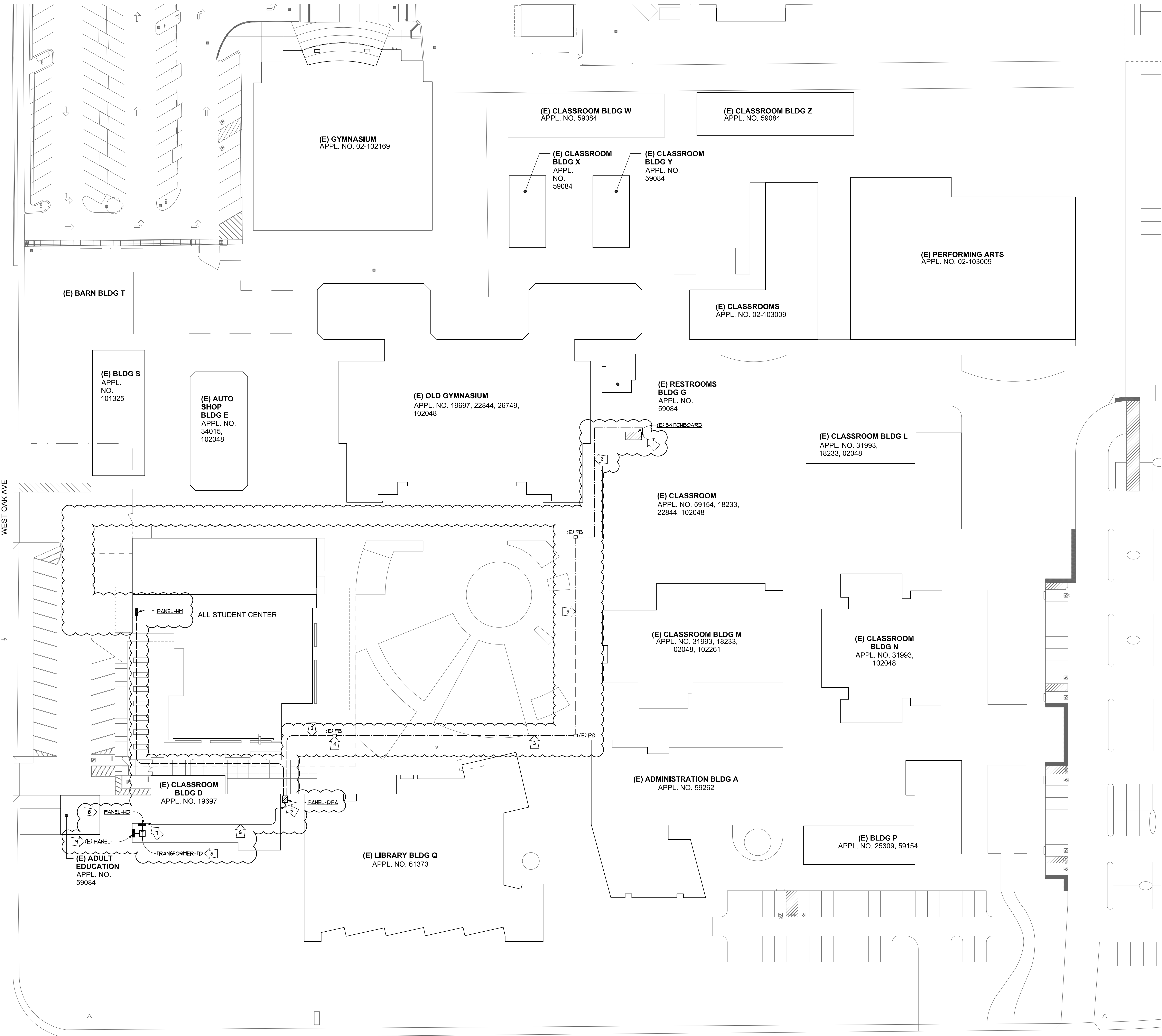

ELECTRICAL SITE PLAN
SCALE: 1" = 30'-0"

PANEL-K1											
MINIMUM AIC: 22,000 TYPE: NQOD-42-4AB-100 MOUNTING: <input checked="" type="checkbox"/> FLUSH <input type="checkbox"/> SURFACE <input type="checkbox"/> FREESTANDING MISC: .						VOLTAGE: <input checked="" type="checkbox"/> 120/208 <input type="checkbox"/> 480/277 <input type="checkbox"/> 120/240 PHASE: <input type="checkbox"/> 1-PHASE <input checked="" type="checkbox"/> 3-PHASE BUSB AMP'S: 400 <input checked="" type="checkbox"/> CU <input type="checkbox"/> AL MAIN AMP'S: 400 <input type="checkbox"/> MLO <input checked="" type="checkbox"/> BKR FED FROM: PANEL-LM					
KVA	USE	BKR	No.	Phase	No.	BKR	USE	KVA			
1.2	E1	20/1	1	A	2						
1.1	E2		3	B	4	50/3	E48	8.1			
0.3	E7		5	C	6						
0.2	E4		1	A	8	20/2	E3	2.0			
0.6	E5		9	B	10						
0.6	E11		11	C	12	1P	SPACE				
	E14		13	A	14	15/2	E29	0.2			
	SPARE		15	B	16						
			17	C	18						
			19	A	20	45/3	E30	12			
			21	B	22						
			23	C	24	60/3	E42	16.2			
			25	A	26						
			27	B	28						
			29	C	30						
			31	A	32	40/3	E43	5.6			
			33	B	34						
			35	C	36						
			37	A	38	110/3	E44	30.2			
			39	B	40						
			41	C	42	1P	SPACE	--			

LOAD KVA: 18.9

PANEL-K2											
MINIMUM AIC: 22,000 TYPE: NQOD-42-4AB-150 MOUNTING: <input type="checkbox"/> FLUSH <input type="checkbox"/> SURFACE <input type="checkbox"/> FREESTANDING MISC: .						VOLTAGE: <input type="checkbox"/> 120/208 <input type="checkbox"/> 480/277 <input type="checkbox"/> 120/240 PHASE: <input type="checkbox"/> 1-PHASE <input checked="" type="checkbox"/> 3-PHASE BUSB AMP'S: 225 <input checked="" type="checkbox"/> CU <input type="checkbox"/> AL MAIN AMP'S: 150 <input type="checkbox"/> MLO <input checked="" type="checkbox"/> BKR FED FROM: PANEL-LM					
KVA	USE	BKR	No.	Phase	No.	BKR	USE	KVA			
1.2	RECEPTACLE	20/1	1	A	2	20/1	E34	1.0			
1.2			3	B	4		E35	1.6			
0.1	E7		5	C	6		E45	1.5			
0.8	E8		1	A	8		E45	1.5			
1.5	E9		9	B	10		E45	1.5			
1.5	E9		11	C	12		E45	1.5			
1.1	E26		13	A	14		E41	0.9			
1.2	RECEPTACLE		15	B	16		RECEPTABLES	1.2			
1.2			17	C	18			1.2			
1.6	E31		19	A	20		SPARE				
1.5	E28		21	B	22						
1.5	E28		23	C	24						
1.6	E32		25	A	26						
1.2	E33		27	B	28						
1.0	E34		29	C	30						
1.6	E35		31	A	32						
0.8	E36		33	B	34						
1.2	E33		35	C	36						
1.0	E34		37	A	38						
1.6	E35		39	B	40						
	SPARE		41	C	42						

LOAD KVA: 36.9

PANEL-K3											
MINIMUM AIC: 22,000 TYPE: NQOD-42-4AB-100 MOUNTING: <input type="checkbox"/> FLUSH <input type="checkbox"/> SURFACE <input type="checkbox"/> FREESTANDING MISC: SHUNT TRIP MAIN						VOLTAGE: <input type="checkbox"/> 120/208 <input type="checkbox"/> 480/277 <input type="checkbox"/> 120/240 PHASE: <input type="checkbox"/> 1-PHASE <input checked="" type="checkbox"/> 3-PHASE BUSB AMP'S: 100 <input checked="" type="checkbox"/> CU <input type="checkbox"/> AL MAIN AMP'S: 100 <input type="checkbox"/> MLO <input checked="" type="checkbox"/> BKR FED FROM: PANEL-LM					
KVA	USE	BKR	No.	Phase	No.	BKR	USE	KVA			
0.8	E16	20/1	1	A	2	20/1	E36	0.8			
0.8	E16		3	B	4		SPACE				
	SPARE		5	C	6						
0.8	E18		1	A	8						
0.6	E25		9	B	10						
0.6	E25		11	C	12						
1.8	E11 & E31		13	A	14						
			15	B	16						
14.4	E19	50/3	17	C	18						
	SPARE	20/1	19	A	20						
			21	B	22						
			23	C	24						
			25	A	26						
			27	B	28						
			29	C	30						
	SPACE	1P	31	A	32	1P	SPACE				
			33	B	34						
			35	C	36						
			37	A	38						
			39	B	40						
			41	C	42						

LOAD KVA: 20.6

NOTE PANEL-K3:

ALL BREAKER TO HAVE GROUND FAULT
CIRCUIT INTERRUPTER (GFCI).

PANEL-HM											
MINIMUM AIC: 65,000 TYPE: NF-42-4AB-800 MOUNTING: <input type="checkbox"/> FLUSH <input checked="" type="checkbox"/> SURFACE <input type="checkbox"/> FREESTANDING MISC: .						VOLTAGE: <input type="checkbox"/> 120/208 <input checked="" type="checkbox"/> 480/277 <input type="checkbox"/> 120/240 PHASE: <input type="checkbox"/> 1-PHASE <input checked="" type="checkbox"/> 3-PHASE BUSB AMP'S: 800 <input checked="" type="checkbox"/> CU <input type="checkbox"/> AL MAIN AMP'S: 800 <input type="checkbox"/> MLO <input checked="" type="checkbox"/> BKR FED FROM: DPA					
KVA	USE	BKR	No.	Phase	No.	BKR	USE	KVA			
64.9	AC-1	100/3	1	A	2	100/3	PANEL-HML	10.6			
			3	B	4						
			5	C	6						
10.4	AC-2	15/3	9	B	10	300/3	TRANSFORMER-TM PANEL-LM	150			
			11	C	12						
13.4	AC-3	20/3	13	A	14	250/3	(E) TRANSFORMER	150			
			15	B	16						
			17	C	18						
13.4	AC-4		19	A	20						
			21	B	22	3P	SPACE	--			
			23	C	24						
31.0	AC-5	50/3	25	A	26						
			27	B	28						
			29	C	30						
			31	A	32						
6.3	KEF-1	15/3	33	B	34						
			35	C	36						
			37	A	38						
			39	B	40						
1.2	KEF-2		41	C	42						

LOAD KVA: 456.0

PANEL-HML											
MINIMUM AIC: . TYPE: . MOUNTING: <input type="checkbox"/> FLUSH <input checked="" type="checkbox"/> SURFACE <input type="checkbox"/> FREESTANDING MISC: .						VOLTAGE: <input type="checkbox"/> 120/208 <input checked="" type="checkbox"/> 480/277 <input type="checkbox"/> 120/240 PHASE: <input type="checkbox"/> 1-PHASE <input checked="" type="checkbox"/> 3-PHASE BUSB AMP'S: 100 <input checked="" type="checkbox"/> CU <input type="checkbox"/> AL MAIN AMP'S: 100 <input type="checkbox"/> MLO <input checked="" type="checkbox"/> BKR FED FROM: PANEL-HM					
KVA	USE	BKR	No.	Phase	No.	BKR	USE	KVA			
1.9	LIGHTING	20/1	1	A	2	20/1	OUTSIDE LIGHT	0.5			
2.9			3	B	4		NIGHT LIGHT	0.3			
2.6			5	C	6		SPARES				
1.1			1	A	8						
1.3			9	B	10						
	SPACE	1P	11	C	12	1P	SPACE				
			13	A	14						
			15	B	16						
			17	C	18						
			19	A	20						
			21	B	22						
			23	C	24						
			25	A	26						
			27	B	28						
			29	C	30						
			31	A	32						
			33	B	34						
			35	C	36						
			37	A	38						
			39	B	40						
			41	C	42						

LOAD KVA: 10.6

PANEL-LM											
MINIMUM AIC: 22,000 TYPE: NQOD-42-4AB-600 MOUNTING: <input type="checkbox"/> FLUSH <input type="checkbox"/> SURFACE <input type="checkbox"/> FREESTANDING MISC: .						VOLTAGE: <input type="checkbox"/> 120/208 <input type="checkbox"/> 480/277 <input type="checkbox"/> 120/240 PHASE: <input type="checkbox"/> 1-PHASE <input checked="" type="checkbox"/> 3-PHASE BUSB AMP'S: 600 <input checked="" type="checkbox"/> CU <input type="checkbox"/> AL MAIN AMP'S: 600 <input type="checkbox"/> MLO <input checked="" type="checkbox"/> BKR FED FROM: PANEL-HM					
KVA	USE	BKR	No.	Phase	No.	BKR	USE	KVA			
0.1	REF-1	20/1	1	A	2						
0.2	REF-2, 3		3	B	4	3P	SPACE				
	B-1 & B-2		5	C	6						
	HWP-1		1	A	8						
	HWP-2		9	B	10	100/3	PANEL-LMP	14.2			
	GWH-1		11	C	12						
	CP-1 & CP-2		13	A	14						
	LC/DRC		15	B	16	400/3	PANEL-K1	78.9			
	SPARE		17	C	18						
			19	A	20						
			21	B	22	150/3	PANEL-K2	36.9			
			23	C	24						
			25	A	26						
			27	B	28	100/3	PANEL-K3	20.6			
			29	C	30						
			31	A	32	20/1	SPARE	--			
			33	B	34						
			35	C	36						
0.2	FC-1	15/2	37	A	38						
			39	B	40						
2.6	SHP-1		41	C	42						

LOAD KVA: 154.3

(QND) (NEUT)

PANEL-DPA

MINIMUM AIC: 65,000

TYPE:

MOUNTING: ☐ FLUSH ☐ SURFACE ☒ FREESTANDING

MISC: NEHA-3R

VOLTAGE: ☐ 120/208 ☒ 480/277 ☐ 120/240

PHASE: ☐ 1-PHASE ☒ 3-PHASE

BUSB AMP'S: 1000 ☒ CU ☐ AL

MAIN AMP'S: 1000 ☐ MLO ☒ BKR

FED FROM: SHED

KVA	USE	BKR	No.	Phase	No.	BKR	USE	KVA
456	PANEL-HM	800/3	1	A	2	3P	SPACE	
			3	B	4			
			5	C	6			
115	PANEL-HD	225/3	7	A	8			
			9	B	10			
			11	C	12			
	SPACE	3P	13	A	14			
			15	B	16			
			17	C	18			
			19	A	20			
			21	B	22			
			23	C	24			