

Alt. Staff Parking

Google Earth Pro

feet
meters



HOLMES Jr. HS

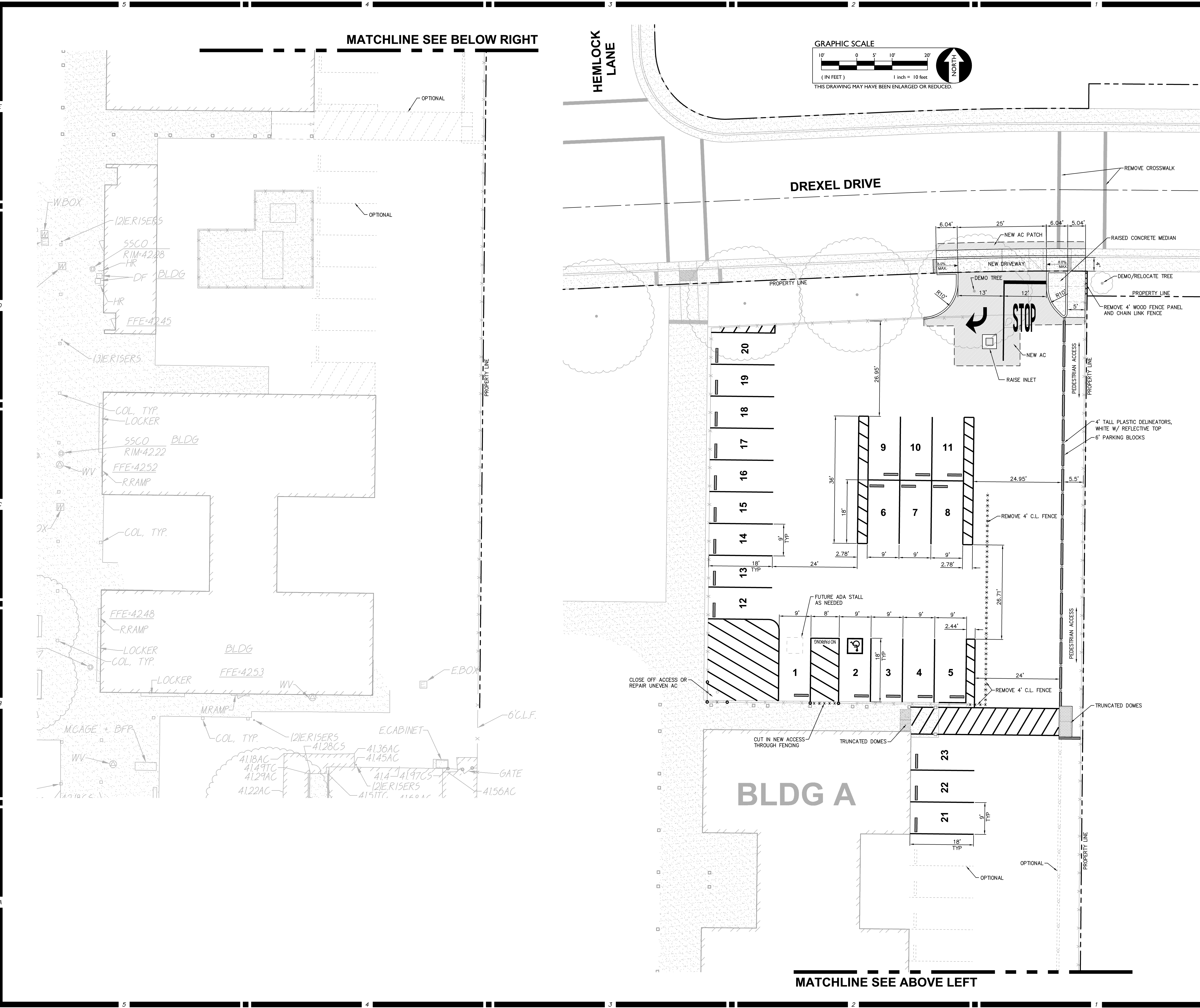

HMC Architects

300 Capitol Mall, Studio 1230 / Sacramento, CA 95814
T 916 325 1100 / www.hmcarchitects.com

REGISTERED PROFESSIONAL ENGINEER
THOMAS E. FASSBENDER
No. C48254
CIVIL
STATE OF CALIFORNIA

WCE

WARREN CONSULTING ENGINEERS, INC.

1117 WINDFIELD WAY, SUITE 110
EL DORADO HILLS, CA 95762 (916) 985-1870

Agency Approval

Project Title:
**D.J.U.S.D.
Oliver Wendell Holmes
Jr. High School**
1220 Drexel Drive
Davis, CA 95616
(530) 757-5445

No.	Description	Date	No.	Description	Date
ASI No.1		6-3-2013			

Drawing Title:
PRELIMINARY SITE PLAN

Architect's Seal

Designed:
SMN

Drawn:
SMN

QAQC:
GW

Date:
10/1/2015

Project No.
-

Scale:
As Noted

Drawing No.
C1

Project Navigator

I:\15-008\CML\DWG\Parking Area\15-0082-C1.dwg

10/1/2015 7:04 PM

Seth Nisbet

PLEASE RECYCLE

DESIGN DEVELOPMENT

