



Reference is hereby made to the following  
parcel map for the lines and dimensions  
of parcels within this Assessment Diagram.

APNs:  
068-130-002

SCI Consulting Group  
4745 Mangels Blvd.  
Fairfield, CA 94534  
(707) 430-4300

#### LEGEND

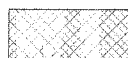

Subject Properties



Annexation Boundary



#### SECRETARY'S MAP FILING STATEMENT

FILED IN THE OFFICE OF THE SECRETARY OF THE BOARD  
OF THE DAVIS JOINT UNIFIED SCHOOL DISTRICT, STATE OF  
CALIFORNIA, THIS \_\_\_\_\_ DAY OF \_\_\_\_\_ 2015.

\_\_\_\_\_  
SECRETARY OF THE BOARD

#### SECRETARY'S MAP CERTIFICATE

I DO HEREBY CERTIFY THAT THE WITHIN MAP  
SHOWING THE PROPOSED BOUNDARIES OF ANNEXATION  
NO. 8 TO THE COMMUNITY FACILITIES DISTRICT (NO. 2),  
DAVIS JOINT UNIFIED SCHOOL DISTRICT, COUNTY OF YOLO,  
STATE OF CALIFORNIA, WAS APPROVED BY THE BOARD OF  
TRUSTEES OF THE DAVIS JOINT UNIFIED SCHOOL DISTRICT  
AT A MEETING THEREOF, HELD ON THE 19TH DAY OF  
MARCH, 2015, BY ITS RESOLUTION NO. \_\_\_\_\_

\_\_\_\_\_  
SECRETARY OF THE BOARD

#### RECORDER'S CERTIFICATE

FILED THIS \_\_\_\_\_ DAY OF \_\_\_\_\_, 2015 AT THE  
HOUR OF \_\_\_\_\_ O'CLOCK \_\_\_\_\_ M. IN BOOK  
\_\_\_\_\_ OF MAPS OF ASSESSMENT AND COMMUNITY  
FACILITIES DISTRICTS AT PAGE \_\_\_\_\_ IN THE  
OFFICE OF THE COUNTY RECORDER IN THE COUNTY OF  
YOLO, STATE OF CALIFORNIA.

\_\_\_\_\_  
COUNTY RECORDER, COUNTY OF YOLO

NOTE:  
REFERENCE IS HEREBY MADE TO THE MAPS  
AND DEEDS OF RECORD IN THE OFFICE OF  
THE ASSESSOR OF THE COUNTY OF YOLO  
FOR A DETAILED DESCRIPTION OF THE LINES  
AND DIMENSIONS OF ANY PARCELS SHOWN  
HEREIN. THOSE MAPS SHALL GOVERN FOR  
ALL DETAILS CONCERNING THE LINES AND  
DIMENSIONS OF SUCH PARCELS. EACH  
PARCEL IS IDENTIFIED IN SAID MAPS BY  
ITS DISTINCTIVE ASSESSOR'S PARCEL  
NUMBER.

## ANNEXATION MAP #8 OF COMMUNITY FACILITIES DISTRICT NO. 2 OF THE DAVIS JOINT UNIFIED SCHOOL DISTRICT CITY OF DAVIS, YOLO COUNTY, CALIFORNIA

ref. Map of Proposed Boundary Annexation No. 8,  
book 068, page 130, parcel 002,  
recorded \_\_\_\_\_, 2015

Page 1 of 3 (El Macero Villas)

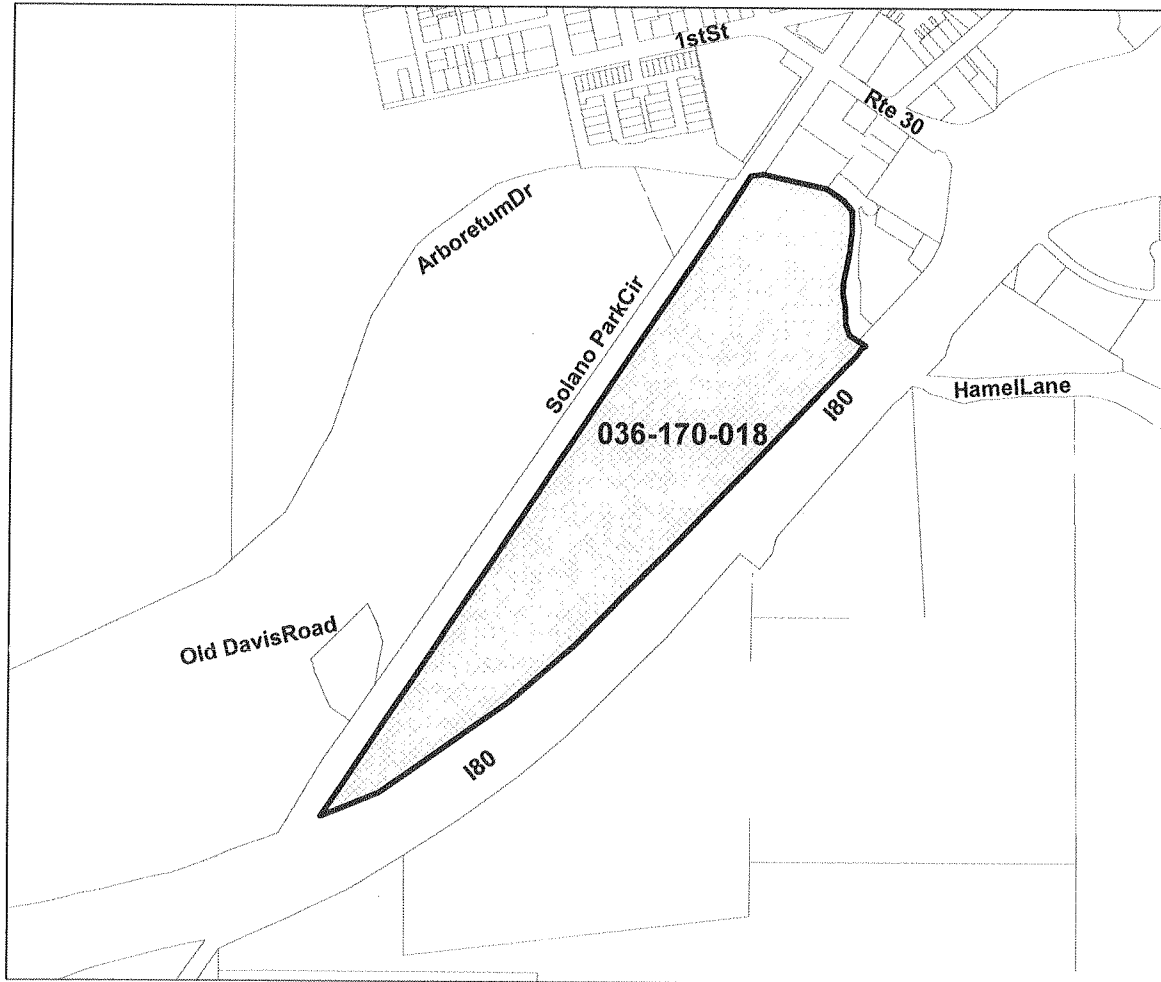

Reference is hereby made to the following parcel map for the lines and dimensions of parcels within this Assessment Diagram.

APNs:  
036-170-018

SCI Consulting Group  
4745 Mangels Blvd.  
Fairfield, CA 94534  
(707) 430-4300

#### LEGEND



Subject Properties



Annexation Boundary



#### SECRETARY'S MAP FILING STATEMENT

FILED IN THE OFFICE OF THE SECRETARY OF THE BOARD OF THE DAVIS JOINT UNIFIED SCHOOL DISTRICT, STATE OF CALIFORNIA, THIS \_\_\_\_\_ DAY OF \_\_\_\_\_ 2015.

\_\_\_\_\_  
SECRETARY OF THE BOARD

#### SECRETARY'S MAP CERTIFICATE

I DO HEREBY CERTIFY THAT THE WITHIN MAP SHOWING THE PROPOSED BOUNDARIES OF ANNEXATION NO. 8 TO THE COMMUNITY FACILITIES DISTRICT (NO. 2), DAVIS JOINT UNIFIED SCHOOL DISTRICT, COUNTY OF YOLO, STATE OF CALIFORNIA, WAS APPROVED BY THE BOARD OF TRUSTEES OF THE DAVIS JOINT UNIFIED SCHOOL DISTRICT AT A MEETING THEREOF, HELD ON THE 19TH DAY OF MARCH, 2015, BY ITS RESOLUTION NO. \_\_\_\_\_

\_\_\_\_\_  
SECRETARY OF THE BOARD

#### RECORDER'S CERTIFICATE

FILED THIS \_\_\_\_\_ DAY OF \_\_\_\_\_, 2015 AT THE HOUR OF \_\_\_\_\_ O'CLOCK \_\_\_\_\_ M. IN BOOK \_\_\_\_\_ OF MAPS OF ASSESSMENT AND COMMUNITY FACILITIES DISTRICTS AT PAGE \_\_\_\_\_ IN THE OFFICE OF THE COUNTY RECORDER IN THE COUNTY OF YOLO, STATE OF CALIFORNIA.

\_\_\_\_\_  
COUNTY RECORDER, COUNTY OF YOLO

NOTE:  
REFERENCE IS HEREBY MADE TO THE MAPS AND DEEDS OF RECORD IN THE OFFICE OF THE ASSESSOR OF THE COUNTY OF YOLO FOR A DETAILED DESCRIPTION OF THE LINES AND DIMENSIONS OF ANY PARCELS SHOWN HEREIN. THOSE MAPS SHALL GOVERN FOR ALL DETAILS CONCERNING THE LINES AND DIMENSIONS OF SUCH PARCELS. EACH PARCEL IS IDENTIFIED IN SAID MAPS BY ITS DISTINCTIVE ASSESSOR'S PARCEL NUMBER.

## ANNEXATION MAP #8 OF COMMUNITY FACILITIES DISTRICT NO. 2 OF THE DAVIS JOINT UNIFIED SCHOOL DISTRICT CITY OF DAVIS, YOLO COUNTY, CALIFORNIA

ref. Map of Proposed Boundary Annexation No. 8,  
book 036, page 170, parcel 018,  
recorded \_\_\_\_\_, 2015

Page 2 of 3 (Nishi Gateway LLC)

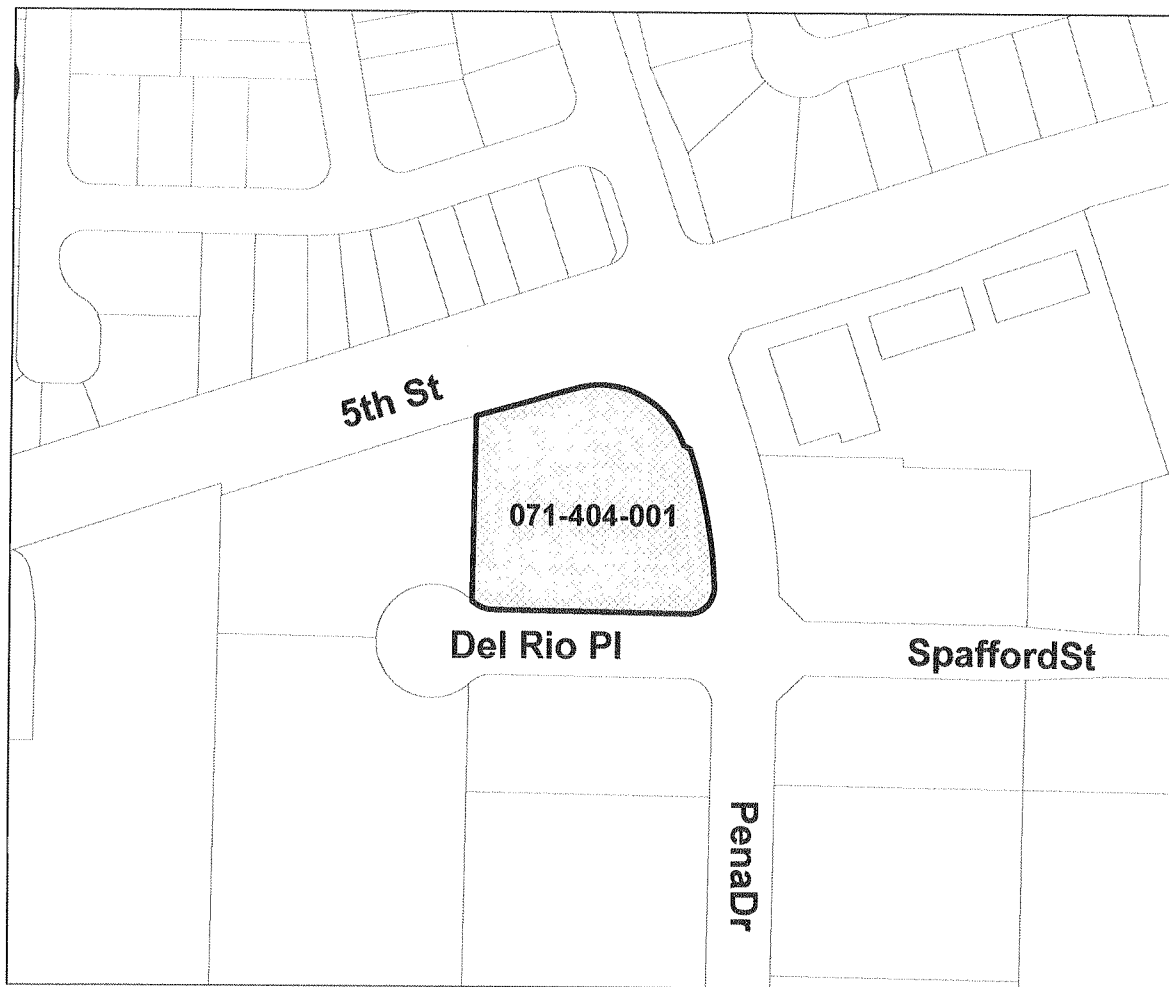

Reference is hereby made to the following parcel map for the lines and dimensions of parcels within this Assessment Diagram.

APNs:  
071-404-001

SCI Consulting Group  
4745 Mangels Blvd.  
Fairfield, CA 94534  
(707) 430-4300

#### LEGEND



Subject Properties



Annexation Boundary



#### SECRETARY'S MAP FILING STATEMENT

FILED IN THE OFFICE OF THE SECRETARY OF THE BOARD OF THE DAVIS JOINT UNIFIED SCHOOL DISTRICT, STATE OF CALIFORNIA, THIS \_\_\_\_\_ DAY OF \_\_\_\_\_ 2015.

\_\_\_\_\_  
SECRETARY OF THE BOARD

#### SECRETARY'S MAP CERTIFICATE

I DO HEREBY CERTIFY THAT THE WITHIN MAP SHOWING THE PROPOSED BOUNDARIES OF ANNEXATION NO. 8 TO THE COMMUNITY FACILITIES DISTRICT (NO. 2), DAVIS JOINT UNIFIED SCHOOL DISTRICT, COUNTY OF YOLO, STATE OF CALIFORNIA, WAS APPROVED BY THE BOARD OF TRUSTEES OF THE DAVIS JOINT UNIFIED SCHOOL DISTRICT AT A MEETING THEREOF, HELD ON THE 19TH DAY OF MARCH, 2015, BY ITS RESOLUTION NO. \_\_\_\_\_

\_\_\_\_\_  
SECRETARY OF THE BOARD

#### RECORDER'S CERTIFICATE

FILED THIS \_\_\_\_\_ DAY OF \_\_\_\_\_, 2015 AT THE HOUR OF \_\_\_\_\_ O'CLOCK \_\_\_\_\_ M. IN BOOK \_\_\_\_\_ OF MAPS OF ASSESSMENT AND COMMUNITY FACILITIES DISTRICTS AT PAGE \_\_\_\_\_ IN THE OFFICE OF THE COUNTY RECORDER IN THE COUNTY OF YOLO, STATE OF CALIFORNIA.

\_\_\_\_\_  
COUNTY RECORDER, COUNTY OF YOLO

NOTE:  
REFERENCE IS HEREBY MADE TO THE MAPS AND DEEDS OF RECORD IN THE OFFICE OF THE ASSESSOR OF THE COUNTY OF YOLO FOR A DETAILED DESCRIPTION OF THE LINES AND DIMENSIONS OF ANY PARCELS SHOWN HEREIN. THOSE MAPS SHALL GOVERN FOR ALL DETAILS CONCERNING THE LINES AND DIMENSIONS OF SUCH PARCELS. EACH PARCEL IS IDENTIFIED IN SAID MAPS BY ITS DISTINCTIVE ASSESSOR'S PARCEL NUMBER.

## ANNEXATION MAP #8 OF COMMUNITY FACILITIES DISTRICT NO. 2 OF THE DAVIS JOINT UNIFIED SCHOOL DISTRICT CITY OF DAVIS, YOLO COUNTY, CALIFORNIA

ref. Map of Proposed Boundary Annexation No. 8,  
book 071, page 404, parcel 001,  
recorded \_\_\_\_\_, 2015

Page 3 of 3 (Del Rio Live Work)